

Instructions for Use
TREMFYA®
(guselkumab)
100 mg Pre-filled pen for subcutaneous use
One-Press® Patient-Controlled Injector

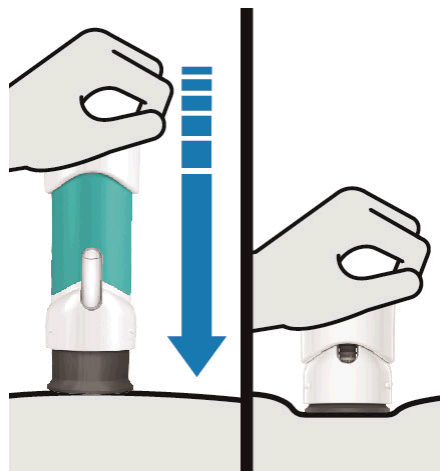

Important

If your doctor decides that you or a caregiver may be able to give your injections of TREMFYA at home, you should receive training on the right way to prepare and inject TREMFYA using the One-Press injector. Please read these “Instructions for use” before using the TREMFYA One-Press injector and each time you get a new One-Press injector. There may be new information.

This instruction guide does not take the place of talking with your doctor about your medical condition or your treatment.

Please also read the Package Leaflet carefully before starting your injection and discuss any questions you may have with your doctor or nurse.

The TREMFYA One-Press injector is intended for injection under the skin, not into the muscle or vein.

During injection, push handle all the way down until teal body is not visible to inject the full dose.

DO NOT LIFT THE ONE-PRESS INJECTOR during injection. If you do, the one-press injector will lock and you will not get the full dose.

After injection, the needle will retract into the body of the device and lock into place. The yellow band indicates that the needle guard is locked.



Storage information

Store in refrigerator at 2° to 8°C.

Do not freeze.

Do not shake the One-Press injector at any time.

Keep TREMFYA One-Press injector out of reach of children.

One-Press injector parts

Before use

AFTER USE

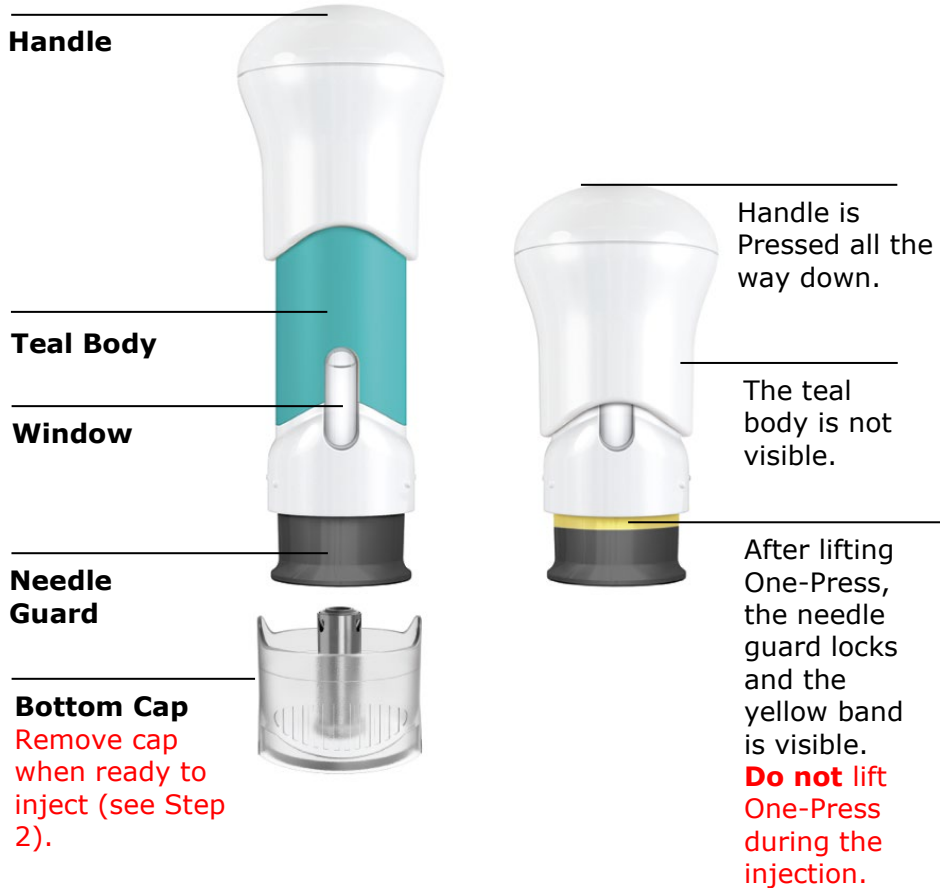

You will need:

- 1 One-Press injector
- Not provided in the carton:**
- 1 Alcohol swab
- 1 Cotton ball or gauze pad
- 1 Adhesive bandage
- 1 Sharps container (See Step 3)

1. Prepare for your injection

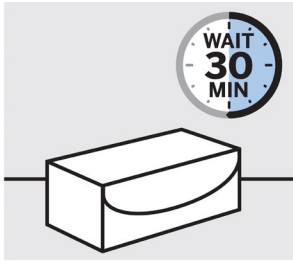

Inspect carton and allow One-Press Injector to come to room temperature

Remove your One-Press injector carton from the refrigerator.

Keep your One-Press injector in the carton and let it sit on a flat surface at room temperature for **approximately 30 minutes** before use.

Do not warm any other way.

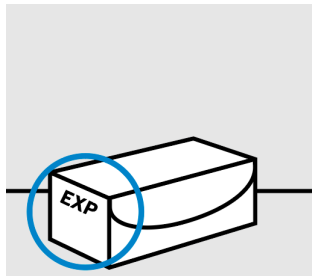

Check the expiration date ('EXP') on the carton.

Do not use if the expiration date has passed.

Do not inject TREMFYA if the seal on the carton is broken. Call your doctor or pharmacist for a new One-Press injector.



Choose injection site

Select from the following areas for your injection:

- **Front of thighs** (recommended)
- Lower stomach area (lower abdomen)
Do not use the 5-centimetre area around your belly-button.
- Back of upper arms (if a caregiver is giving you the injection)

Do not inject into skin that is tender, bruised, red, scaly, hard, thick, has scars

or stretch marks or affected by psoriasis.

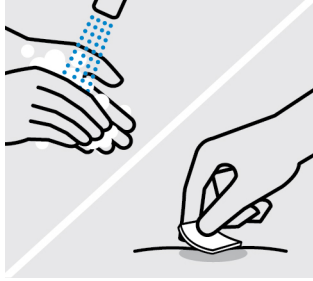

Wash hands

Wash your hands well with soap and warm water.

Clean injection site

Wipe your chosen injection site with an alcohol swab and allow it to dry.

Do not touch, fan, or blow on the injection site after you have cleaned it.

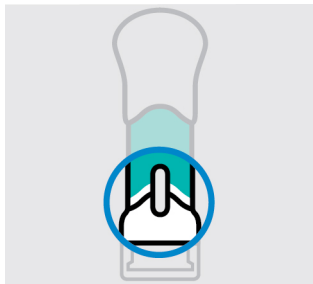

Inspect liquid in window

Take your One-Press injector out of the carton.

Check the liquid in the window. It should be clear to slightly yellow and may contain tiny white or clear particles. You may also see one or more air bubbles. This is normal.

Do not inject if the liquid is:

- cloudy or
- discoloured, or
- has large particles.

If you are uncertain, call your doctor or pharmacist for a new One-Press injector.

2. Inject TREMFYA using the One-Press injector

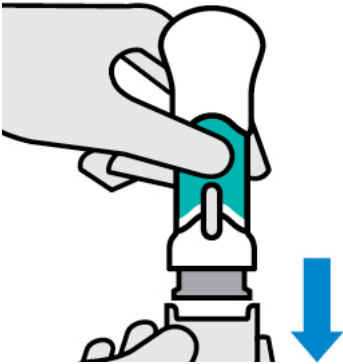

Pull off bottom cap when you are ready to inject

Keep hands away from the needle guard after the cap is removed. It is normal to see a few drops of liquid.

Inject within 5 minutes of removing the cap.

Do not put the cap back on. This could damage the needle.

Do not use the One-Press injector if it is dropped after removing the cap. Call your doctor or pharmacist for a new One-Press injector.

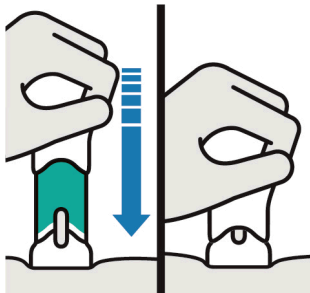

Place One-Press Injector straight on skin

Push handle all the way down until teal body is not visible

DO NOT LIFT ONE-PRESS INJECTOR DURING THE INJECTION

If you do, the needle guard will lock, showing a yellow band, and you will not get the full dose.

- You may hear a click when the injection begins. Keep pushing.
- **If you feel resistance, keep pushing. This is normal.**

The medication injects as you push. Do this at a speed that is comfortable for you.

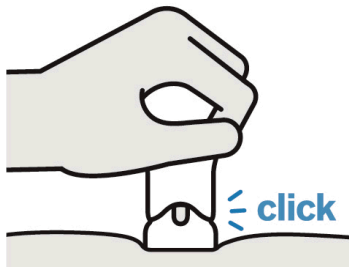

Confirm your injection is complete

Your injection is complete when:

- The teal body is no longer visible
- You cannot press the handle down anymore
- You may hear a click

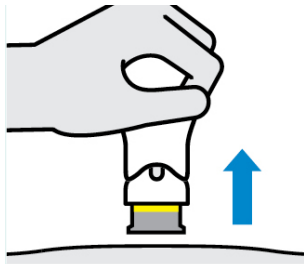

Lift straight up

The yellow band indicates that the needle guard is locked.

3. After your injection



Throw your used One-Press injector in the sharps disposal container

Put your used One-Press injector in a sharps disposal container right away after use.

Make sure you dispose of the bin as instructed by your doctor or nurse when the container is full.

Do not throw away (dispose of) your One-Press injector in your household waste.

Do not recycle your used sharps disposal container.

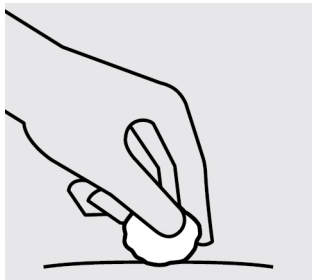

Check injection site

There may be a small amount of blood or liquid at the injection site. Hold pressure over your skin with a cotton ball or gauze pad until any bleeding stops.

Do not rub the injection site.

If needed, cover injection site with a bandage.

Your injection is now complete!



Need help?

Call your doctor to talk about any questions you may have.

The Janssen Immunology Patient Support Program is available to patients prescribed TREMFYA.

Call 1800 666 845

© 2024 Janssen Pharmaceutical Companies

Date of preparation: December 2024

Janssen-Cilag Pty Ltd
Macquarie Park
NSW 2113

